



44 series

STANDARD VERSION



W200
W204
W14200
W16180



VH version



VK version

- All models (excepts for models WW963 - WW964 - WW965 - WW963C - WW964C - WW965C - W200 - W204 - W14200 - W16180) can be supplied with built-in "H" type and "K" type automatic pressure regulators (right).
- Tous les modèles (sauf modèles WW963 - WW964 - WW965 - WW963C - WW964C - WW965C - W200 - W204 - W14200 - W16180) peuvent être livrés avec régulateur automatique de pression incorporé de la série "H" ou "K" (à droite).
- Alle Modelle (Ausschließlich Modelle WW963 - WW964 - WW965 - WW963C - WW964C - WW965C - W200 - W204 - W14200 - W16180) sind mit eingebautem automatischem Druckregulierventil typ "H" und "K" lieferbar (rechts).
- Todos los modelos (excepto modelos WW963 - WW964 - WW965 - WW963C - WW964C - WW965C - W200 - W204 - W14200 - W16180) pueden venir equipados con regulador automatico de presión incorporado (a la derecha), de tipo "H" y "K".
- Tutti i modelli (esclusi WW963 - WW964 - WW965 - WW963C - WW964C - WW965C - W200 - W204 - W14200 - W16180) possono essere forniti con valvola di regolazione automatica incorporata di tipo "H" o di tipo "K" (a destra).

Pump type Type de pompe Pumpentype Tipo de bomba Tipo di pompa	Flow rate Débit Förderleistung Caudal Portata		Max. pressure Pression Druck Presión Pressione			r.p.m. tr./min. u.p.m. r/min. g./min.	Power Puissance Leistung Potencia Potenza		Weight Poids Gewicht Peso Peso	Dimensions Dimensions Dimension Dimensiones Dimensioni
	l/min.	G.P.M. (U.S.A.)	bar	MPa	p.s.i.		kW	hp		
W150	8	2.11	150	15	2175	1450	2,20	3	7,9	225x221x139
W130	9,5	2.5	130	13	1885		2,20	3		
W170	9,5	2.5	170	17	2465		2,94	4		
W112	12	3.17	100	10	1450		2,20	3	7,7	
W140	12	3.17	140	14	2030		2,94	4		
W200	12	3.17	200	20	2900		4,41	6		
W97	14	3.69	90	9	1300		2,20	3		
W124	14	3.69	120	12	1750		2,94	4		
W154	14	3.69	150	15	2175		4,04	5,5		
W204	14	3.69	200	20	2900		5,37	7,3		
W950	9,5	2.5	165	16,5	2400	1750	2,94	4	7,9	225x221x139
W951	11,5	3.04	103	10,3	1500		2,20	3		
W952	11,5	3.04	138	13,8	2000		2,94	4		
W953	11,5	3.04	172	17,2	2500		3,67	5	7,7	
W954	13,6	3.6	90	9	1300		2,20	3		
W955	13,6	3.6	117	11,7	1700		2,94	4		
W956	13,6	3.6	145	14,5	2100		3,67	5		
W14200	13,6	3.6	200	20	2900		5,14	7		
W957	15,9	4.2	76	7,6	1100		2,20	3		
W958	15,9	4.2	96	9,6	1400		2,94	4		
W959	15,9	4.2	124	12,4	1800		3,67	5		
W16180	15,9	4.2	180	18	2610		5,51	7,5		
WW186	13	3.43	180	18	2610		2800	4,04	5,5	
WW206	13	3.43	200	20	2900	5,51		7,5		
WW116	15	3.96	110	11	1600	2,94		4		
WW156	15	3.96	150	15	2175	4,04		5,5		
WW209	15	3.96	200	20	2900	5,51		7,5		
WW189	16	4.22	180	18	2610	5,51		7,5		
WW136	17	4.5	130	13	1885	4,04		5,5		
WW176	17	4.5	170	17	2465	5,51		7,5		
WW963	11	2.9	250	25	3625	3400	5,51	7,5	8,7	225x245x164
WW964	13	3.43	250	25	3625		6,25	8,5		
WW960	13,2	3.48	172	17,2	2500		4,04	5,5		
WW961	15	3.96	172	17,2	2500		4,77	6,5		
WW965	15	3.96	250	25	3600		7,35	10		
WW962	17,4	4.6	172	17,2	2500		5,51	7,5		

Pump type Type de pompe Pumpentype Tipo de bomba Tipo di pompa	Flow rate Débit Förderleistung Caudal Portata		Max. pressure Pression Druck Presión Pressione			r.p.m. tr./min. u.p.m. r/min. g./min.	Power Puissance Leistung Potencia Potenza	
	l/min.	G.P.M. (U.S.A.)	bar	MPa	p.s.i.		kW	hp

W950A	9,5	2.5	165	16,5	2400	1750	2,94	4
W951A	11,5	3.04	103	10,3	1500		2,20	3
W952A	11,5	3.04	138	13,8	2000		2,94	4
W953A	11,5	3.04	172	17,2	2500		3,67	5
W954A	13,6	3.6	90	9	1300		2,20	3
W955A	13,6	3.6	117	11,7	1700		2,94	4
W956A	13,6	3.6	145	14,5	2100		3,67	5
W14200A	13,6	3.6	200	20	2900		5,14	7
W957A	15,9	4.2	76	7,6	1100		2,20	3
W958A	15,9	4.2	96	9,6	1400		2,94	4
W959A	15,9	4.2	124	12,4	1800		3,67	5
W16180A	15,9	4.2	180	18	2610		5,51	7,5

44 series A Version

For electric motor NEMA 184 TC
Pour moteur électrique NEMA 184 TC
Für Elektromotor NEMA 184 TC
Para motor eléctrico NEMA 184 TC
Per motore elettrico NEMA 184 TC

W150B	8	2.11	150	15	2175	1450	2,20	3
W130B	9,5	2.5	130	13	1885		2,20	3
W170B	9,5	2.5	170	17	2465		2,94	4
W112B	12	3.17	100	10	1450		2,20	3
W140B	12	3.17	140	14	2030		2,94	4
W200B	12	3.17	200	20	2900		4,41	6
W97B	14	3.69	90	9	1300		2,20	3
W124B	14	3.69	120	12	1750		2,94	4
W154B	14	3.69	150	15	2175		4,04	5,5
W204B	14	3.69	200	20	2900		5,37	7,3

44 series B Version

For electric motor IEC100-112 B14
Pour moteur électrique IEC100-112 B14
Für Elektromotor IEC100-112 B14
Para motor eléctrico IEC100-112 B14
Per motore elettrico IEC100-112 B14

WW186B	13	3.43	180	18	2610	2800	4,04	5,5
WW206B	13	3.43	200	20	2900		5,51	7,5
WW116B	15	3.96	110	11	1600		2,94	4
WW156B	15	3.96	150	15	2175		4,04	5,5
WW209B	15	3.96	200	20	2900		5,51	7,5
WW136B	17	4.5	130	13	1885		4,04	5,5
WW176B	17	4.5	170	17	2465		5,51	7,5

WW960C 1"	13,2	3.48	172	17,2	2500	3400	4,04	5,5
WW961C 1"	15	3.96	172	17,2	2500		4,77	6,5
WW962C 1"	17,4	4.6	172	17,2	2500		5,51	7,5
WW963C 1"	11	2.9	250	25	3625	3400	5,51	7,5
WW964C 1"	13	3.43	250	25	3625		6,25	8,5
WW965C 1"	15	3.96	250	25	3625		7,35	10

44 series C 1" Version

For gasoline engine SAE J609-B ext. 4
Pour moteur essence SAE J609-B ext. 4
Für Benzinmotor SAE J609-B ext. 4
Para motor de gasolina SAE J609-B ext. 4
Per motore endotermico SAE J609-B ext. 4

All models (excepts for models WW963 - WW964 - WW965 - WW963C - WW964C - WW965C - W200B - W204B - W14200A - W16180A) can be supplied with built-in "H" type and "K" type automatic pressure regulators (right).

Tous les modèles (sauf modèles WW963 - WW964 - WW965 - WW963C - WW964C - WW965C - W200B - W204B - W14200A - W16180A) peuvent être livrés avec régulateur automatique de pression incorporé de la série "H" ou "K" (à droite).

Alle Modelle (Ausschließlich Modelle WW963 - WW964 - WW965 - WW963C - WW964C - WW965C - W200B - W204B - W14200A - W16180A) sind mit eingebautem automatischem Druckregulierventil typ "H" und "K" lieferbar (rechts).

Todos los modelos (excepto modelos WW963 - WW964 - WW965 - WW963C - WW964C - WW965C - W200B - W204B - W14200A - W16180A) pueden venir equipados con regulador automático de presión incorporado, de tipo "H" y "K" (a la derecha).

Tutti i modelli (esclusi WW963 - WW964 - WW965 - WW963C - WW964C - WW965C - W200B - W204B - W14200A - W16180A) possono essere forniti con valvola di regolazione automatica incorporata di tipo "H" o di tipo "K" (a destra).



44 series

**VERSIONS WITH FLANGE
VERSIONS AVEC BRIDE
AUSFÜHRUNGEN MIT FLANSCH
VERSIONES CON BRIDA
VERSIONI CON FLANGIA**

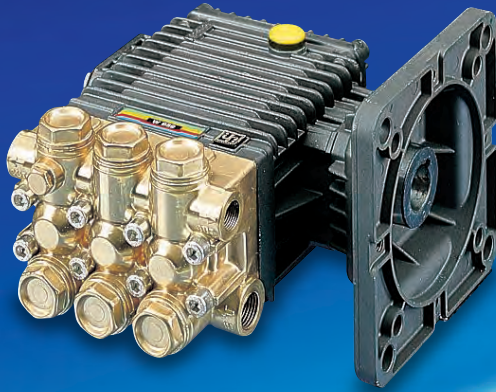

A Version

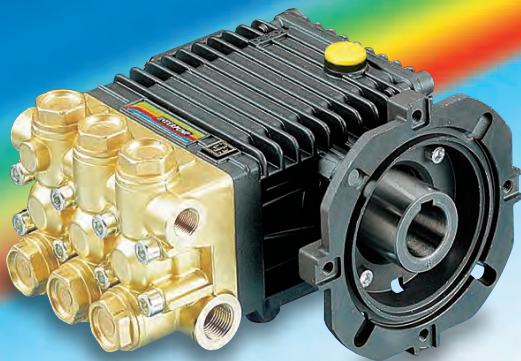
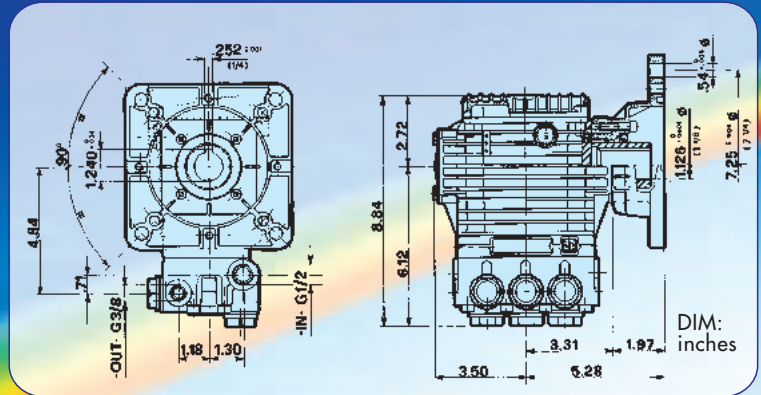

B Version

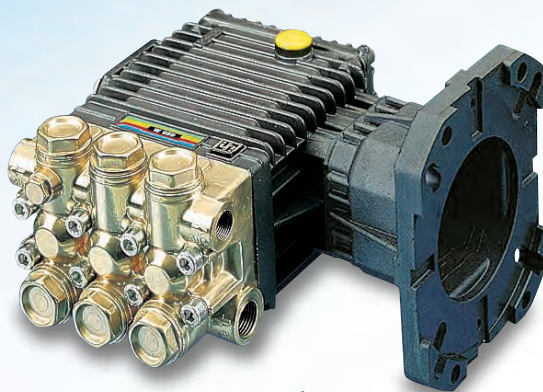
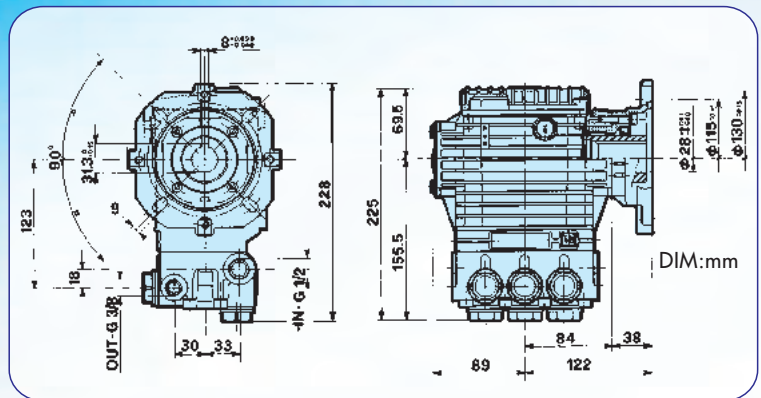

C 1" Version

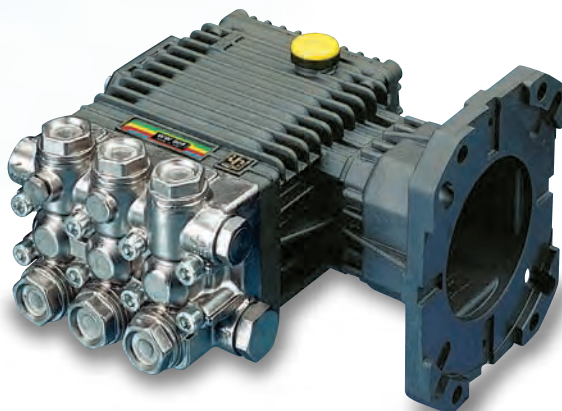
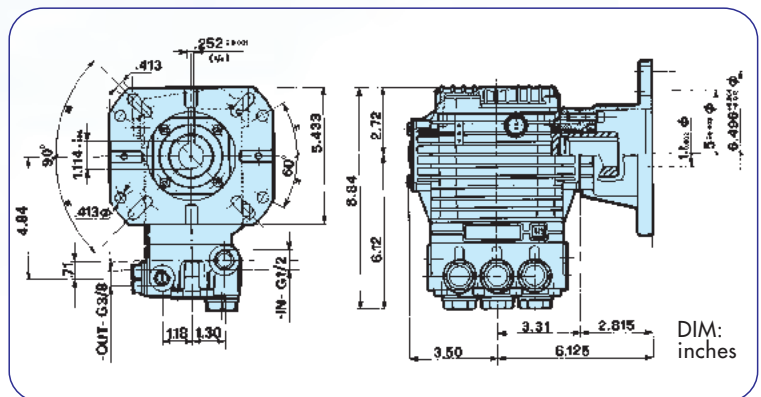

**Brass manifold version
Version culasse laiton
Ausführung Messingkopf
Versión culata latón
Versione testata ottone**

**WW960C 1" - WW961C 1"
WW962C 1" - WW963C 1"
WW964C 1" - WW965C 1"**

**Nickel plated brass version
Version culasse laiton nickelée
Ausführung Messingkopf, vernickelt
Versión culata latón niquelado
Versione testata ottone nichelato**

**WW963C 1"
WW964C 1"
WW965C 1"**



INTERPUMPGROUP

I
GB

ISTRUZIONI D'USO
INSTRUCTIONS FOR USE

F
D

MODE D'EMPLOI
BEDIENUNGSANLEITUNG

E
P

INSTRUCCIONES DE USO
INSTRUÇÕES DE USO

Questo manuale deve essere letto e compreso in accordo al libretto generico "Istruzioni d'uso e manutenzione".
 This manual must be read and followed in accordance with the generic "Instructions for Use and Maintenance" booklet.
 Ce manuel doit être lu et compris en accord avec la notice générale " Mode d'emploi et d'entretien ".
 Dieses Handbuch ist in Verbindung mit dem allgemeinen Handbuch " Gebrauchs- und Wartungsanleitung " zu lesen und zu verstehen.
 Este manual debe leerse y comprenderse de acuerdo con el manual general "Instrucciones de uso y mantenimiento"
 Este manual deve ser lido e interpretado de acordo com o livro genérico "Instruções de uso e manutenção"

44



Modello Model Modèle Modell Modelo	Portata Flow rate Débit Förderstrom Caudal Fluxo		Pressione Pressure Pression Druck Presión Pressão			g/m rpm t/m upm r/m r/m	Potenza Power Puissance Leistung Potencia Poder		Peso Weight Gewicht Gewicht Peso Peso		
	L/min	gpm	bar	MPa	psi		Hp	kW	Kg	Ibs	
W150	8	2.11	150	15	2175	1450	3.0	2.20	7.9	17.4	0.4
W130	9.5	2.11	130	13	1885	1450	3.0	2.20	7.9	17.4	0.4
W130HH	9.5	2.11	130	13	1885	1450	3.0	2.20	7.9	17.4	0.4
W170	9.5	2.50	170	17	2465	1450	4.0	2.94	7.9	17.4	0.4
W112	12	2.50	100	10	1450	1450	3.0	2.20	7.7	17.0	0.4
W140	12	3.17	140	14	2030	1450	4.0	2.94	7.7	17.0	0.4
W140HH	12	3.17	140	14	2030	1450	4.0	2.94	7.7	17.0	0.4
W200	12	3.17	200	20	2900	1450	6.0	4.41	7.7	17.0	0.4
W97	14	3.69	90	9	1300	1450	3.0	2.20	7.7	17.0	0.4
W124	14	3.69	120	12	1750	1450	4.0	2.94	7.7	17.0	0.4
W154	14	3.69	150	15	2175	1450	5.5	4.04	7.7	17.0	0.4
W154HH	14	3.69	150	15	2175	1450	5.5	4.04	7.7	17.0	0.4
W204	14	3.69	200	20	2900	1450	7.3	5.37	7.7	17.0	0.4
W950	9.5	2.50	165	16.5	2400	1750	4.0	2.94	7.9	17.4	0.4
W951	11.5	3.04	103	10.3	1500	1750	3.0	2.20	7.9	17.4	0.4
W952	11.5	3.04	138	13.8	2000	1750	4.0	2.94	7.9	17.4	0.4
W953	11.5	3.04	172	17.2	2500	1750	5.0	3.67	7.9	17.4	0.4
W954	13.6	3.60	90	9	1300	1750	3.0	2.20	7.7	17.0	0.4
W955	13.6	3.60	117	11.7	1700	1750	4.0	2.94	7.7	17.0	0.4
W956	13.6	3.60	145	14.5	2100	1750	5.0	3.67	7.7	17.0	0.4
W14200	13.6	3.60	200	20	2900	1750	7.0	5.14	7.7	17.0	0.4
W957	15.9	4.20	76	7.6	1100	1750	3.0	2.20	7.7	17.0	0.4
W958	15.9	4.20	96	9.6	1400	1750	4.0	2.94	7.7	17.0	0.4
W959	15.9	4.20	124	12.4	1800	1750	5.0	3.67	7.7	17.0	0.4
W16180	15.9	4.20	180	18	2610	1750	7.5	5.51	7.7	17.0	0.4

S
E
R
I
E
S



44
**Modello
Model
Modèle
Modell
Modelo
Modelo**
**Portata
Flow rate
Débit
Förderstrom
Caudal
Fluxo**
**Pressione
Pressure
Pression
Druck
Presión
Pressão**
**g/m
rpm
t/m
upm
r/m
r/m**
**Potenza
Power
Puissance
Leistung
Potencia
Poder**
**Peso
Weight
Poids
Gewicht
Peso
Peso**
**S
E
R
I
E
S**

L/min

gpm

bar

MPa

psi

Hp

kW

Kg

lbs

Lt.

WW186

13

3.43

180

18

2610

2800

5.5

4.04

7.9

17.4

0.4

WW206

13

3.43

200

20

2900

2800

7.5

5.51

7.9

17.4

0.4

WW116

15

3.96

110

11

1600

2800

4.0

2.94

7.9

17.4

0.4

WW156

15

3.96

150

15

2175

2800

5.5

4.04

7.9

17.4

0.4

WW209

15

3.96

200

20

2900

2800

7.5

5.51

7.9

17.4

0.4

WW189

16

4.22

180

18

2610

2800

7.5

5.51

7.9

17.4

0.4

WW136

17

4.50

130

13

1885

2800

5.5

4.04

7.9

17.4

0.4

WW176

17

4.50

170

17

2465

2800

7.5

5.51

7.9

17.4

0.4

WW963

11

2.90

250

25

3600

3400

7.5

5.51

8.7

19.2

0.4

WW964

13

3.43

250

25

3600

3400

8.5

6.25

8.7

19.2

0.4

WW960

13.2

3.48

172

17.2

2500

3400

5.5

4.04

8.7

19.2

0.4

WW961

15

3.96

172

17.2

2500

3400

6.5

4.77

8.7

19.2

0.4

WW965

15

3.96

250

25

3600

3400

10

7.35

8.7

19.2

0.4

WW962

17.4

4.60

172

17.2

2500

3400

7.5

5.51

8.7

19.2

0.4

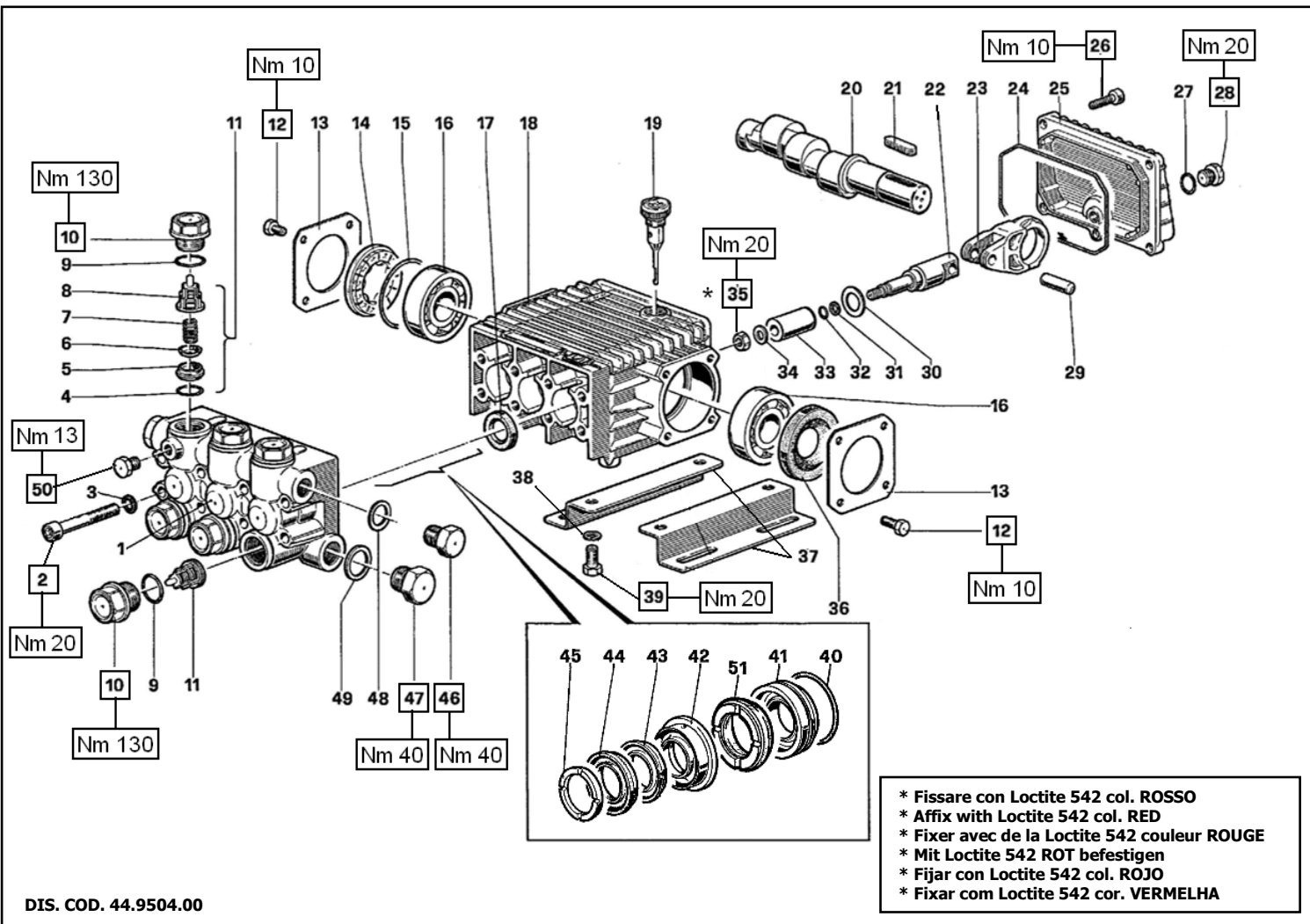

DIS. COD. 44.9504.00

* Fissare con Loctite 542 col. ROSSO
 * Affix with Loctite 542 col. RED
 * Fixer avec de la Loctite 542 couleur ROUGE
 * Mit Loctite 542 ROT befestigen
 * Fijar con Loctite 542 col. ROJO
 * Fixar com Loctite 542 cor. VERMELHA

**KIT RICAMBI – SPARE KITS****OTTONE BRASS****NICKEL****PISTONE- PISTON Ø15****PISTONE- PISTON Ø18**

KIT Nr.	KIT 23	KIT 123	KIT 124	KIT 158	KIT 88	KIT 89	KIT 90	KIT 125	KIT 130	KIT 126	KIT 127	KIT 128	KIT 129	KIT 131
Posizioni incluse Positions included	17	4 – 5 6 – 7 8 – (11)	9 - 10	9 - 10	43 – 44 51	42	45	40 – 41	40 – 41 42 – 43 44 – 45 51	40 – 41	43 – 44 51	42	45	40 – 41 42 – 43 44 – 45 51
Nr. Pcs.	3	6	6	6	3	3	6	3	1	3	3	6	3	1

**W97 - W112 - W124 - W130
W140 - W150 - W154 - W170
W200 - W204 - W950 - W951
W952 - W953 - W954 - W955
W956 - W957 - W958 - W959
W14200 - W16180 - WW116
WW136 - WW156 - WW176
WW186 - WW189 - WW206
WW209 - WW960 - WW961
WW962**

	PISTONE – PISTON Ø15	PISTONE – PISTON Ø18
OTTONE BRASS	W130 – W150 – W170 W950 – W951 – W952 W953 – WW116 – WW136 WW176 – WW186 – WW189 – WW206 WW209 – WW960 – WW961 – WW962	W97 – W112 - W124 W140 - W154 - W954 W955 – W956 - W957 W958 - W959
NICKEL		W200 – W204 W14200 - W16180

POS	COD.	DESCRIZIONE – DESCRIPTION - KIT	NR
1	44.1200.41	Testata Ø 15	1
	44.1204.41	Testata Ø 18	1
	44.1207.41	Testata Ø 18 – NICKEL	1
2	99.3175.00	Vite M8x60 UNI 5931	8
3	96.7014.00	Rosetta Ø 8.4x13x0.8	8
4	90.3841.00	OR Ø 17.13x2.62 (3068)	123 6
5	36.2003.66	Sede valvola	123 6
6	36.2001.76	Valvola	123 6
7	94.7376.00	Molla Ø 9.4x14.8	123 6
8	36.2025.51	Guida valvola	123 6
9	90.3847.00	OR Ø 20.24x2.62 (3081) 90 Sh. 124-158	6
10	98.2226.00	Tappo M24x1.5x17	124
	98.2225.00	Tappo M24x1.5x17 – NICKEL	158 6
11	36.7115.01	Gruppo valvola aspiraz./mand.	123 6
12	99.1807.00	Vite M6x10 UNI 5739	8

POS	COD.	DESCRIZIONE – DESCRIPTION - KIT	NR
13	50.1500.74	Coperchio carter	2
14	44.2118.01	Distanziale con indicatore	1
15	90.4097.00	OR Ø 55.56x3.53 (159)	1
16	91.8331.00	Cuscinetto a sfere 6305 – Spec.	2
17	90.1614.00	Anello rad. Ø 20x30x5 23	3
18	44.0100.22	Carter pompa	1
19	98.2103.00	Tappo carico olio G 3/8"	1
20	44.0200.35	Albero – ww186-ww206	1
	44.0203.35	Albero – W112-W140-W150-W950-W954 W955-W956-WW116-WW156-WW209-W200 W14200	1
	44.0206.35	Albero – ww189	1
21	44.0205.35	Albero – w97-w124-w130-w154-w170 w951-w952-w953-w957-w958-w959 ww136-ww176-w204-w16180	1
	44.0206.35		1
21	91.4892.00	Linguetta 8x7x35 UNI 6604	1
22	44.0500.66	Guida pistone	3
23	44.0300.22	Biella	3
24	90.3920.00	OR Ø 101.27x2.62 (3400)	1
25	44.1600.22	Coperchio posteriore	1
26	99.1837.00	Vite M6x14 UNI 5931	5
27	90.3585.00	OR Ø 10.82x1.78 (2043)	1
28	98.2041.00	Tappo G 1/4"x9	1
29	97.7340.00	Spinotto Ø 10x29.5	3
30	96.7350.00	Rosetta Ø 16x27x1.7/0.7	3
31	90.5022.00	Anello antiest. Ø 6.2x9x1.5	3

POS	COD.	DESCRIZIONE – DESCRIPTION - KIT	NR
32	90.3572.00	OR Ø 5.28x1.78 (2021) – Spec.	3
33	52.0400.09	Pistone Ø 15	3
	44.0401.09	Pistone Ø 18	3
34	44.2115.70	Rosetta Ø 8 con collare	3
35	92.2216.00	Dado M8x13x5 - INOX	3
36	90.1641.00	Anello rad. Ø 25x62x10	1
37	50.2000.74	Piedino	2
38	96.7016.00	Rosetta Ø 8.4 UNI 1751	4
39	99.3037.00	Vite M8x16 UNI 5739	4
40	90.3612.00	OR Ø 31.47x1.78 (2125)	125-126 130-131 3
41	44.0800.70	Anello di fondo Ø 15	125-130 3
	44.0801.70	Anello di fondo Ø 18	126-131 3
42	52.2166.70	Anello intermedio Ø 15	89-130 3
	44.2161.70	Anello intermedio Ø 18	128-131 3
43	90.2622.00	Anello RESTOP Ø 15	88-130 3
	90.2683.00	Anello RESTOP Ø 18	127-131 3
44	90.2620.00	Anello tenuta Ø 15 HP	88-130 3
	90.2682.00	Anello tenuta Ø 18 HP	127-131 3
45	51.1000.51	Anello di testa Ø 15	90-130 3
	44.1001.51	Anello di testa Ø 18	129-131 3
46	98.2100.00	Tappo G 3/8"x13	1
47	98.2176.00	Tappo G 1/2"x10	1
48	96.7380.00	Rosetta Ø 17.5x23x1.5	1
49	96.7514.00	Rosetta Ø 21.5x27x1.5	1
50	98.1966.00	Tappo G 1/8"x8	1
51	90.2617.00	Anello tenuta Ø 15 LP	88-130 3
	90.2684.00	Anello tenuta Ø 18 LP	127-131 3

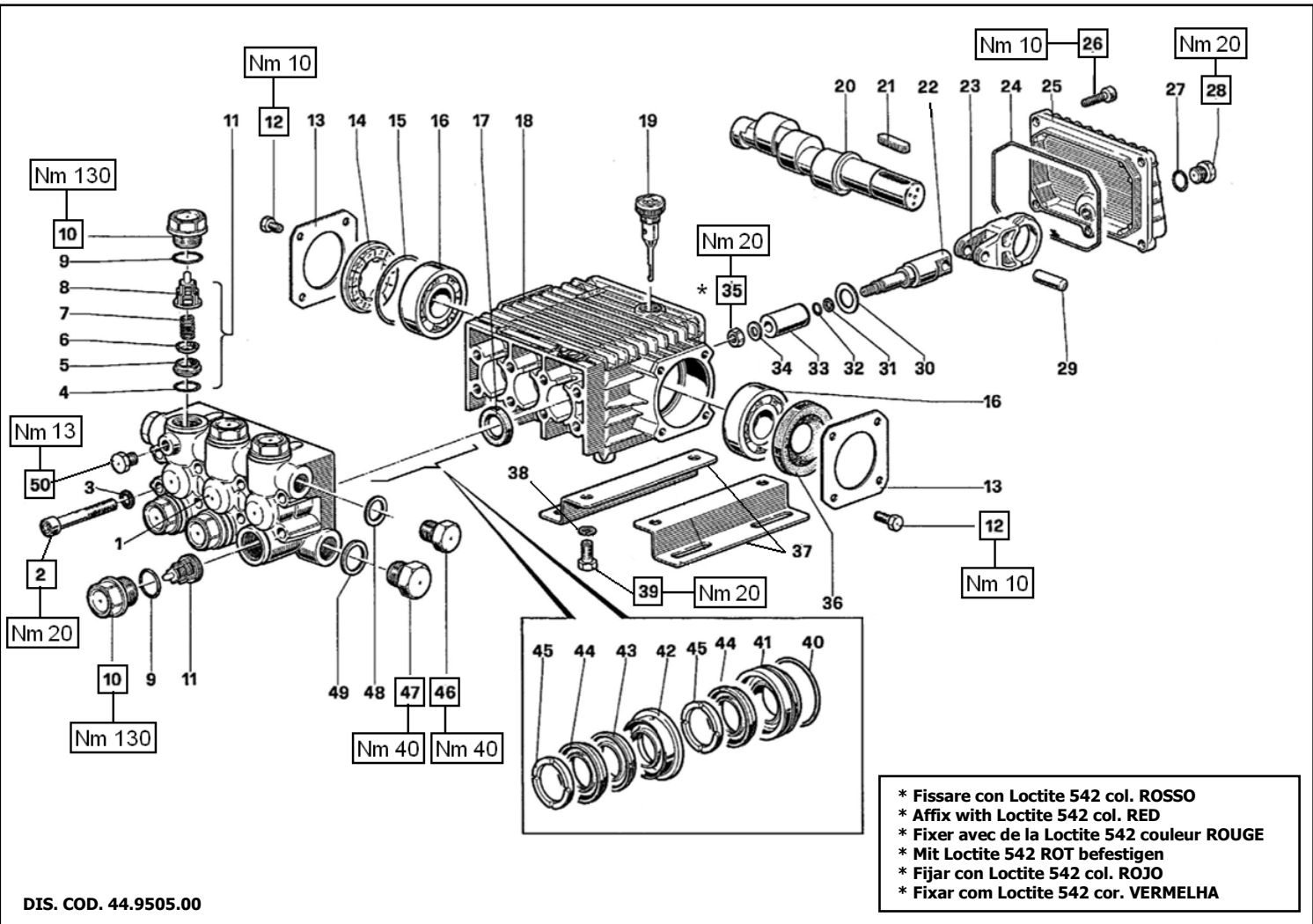



W130HH – W140HH W154HH

KIT RICAMBI – SPARE KITS

PISTONE- PISTON Ø15

PISTONE- PISTON Ø18

KIT Nr.	KIT 23	KIT 123	KIT 124	KIT 250	KIT 89	KIT 90	KIT 125	KIT 126	KIT 251	KIT 128	KIT 129
Posizioni include Positions included	17	4 – 5 6 – 7 8 - (11)	9 - 10	43 – 44	42	45	40 – 41	40 – 41	43 – 44	42	45
Nr. Pcs.	3	6	6	3	3	6	3	3	3	6	3

PISTONE – PISTON -Ø15

PISTONE – PISTON - Ø18

W130HH – W140HH

W154HH

POS	COD.	DESCRIZIONE – DESCRIPTION - KIT	NR
1	44.1200.41 44.1204.41	Testata Ø 15 Testata Ø 18	1 1
2	99.3175.00	Vite M8x60 UNI 5931	8
3	96.7014.00	Rosetta Ø 8.4x13x0.8	8
4	90.3841.00	OR Ø 17.13x2.62 (3068)	123 6
5	36.2003.66	Sede valvola	123 6
6	36.2001.76	Valvola	123 6
7	94.7376.00	Molla Ø 9.4x14.8	123 6
8	36.2025.51	Guida valvola	123 6
9	90.3847.00	OR Ø 20.24x2.62 (3081) 90 Sh.	124 6
10	98.2226.00	Tappo M24x1.5x17	124 6
11	36.7115.01	Gruppo valvola aspiraz./mand.	123 6
12	99.1807.00	Vite M6x10 UNI 5739	8
13	50.1500.74	Coperchio carter	2
14	44.2118.01	Distanziale con indicatore	1
15	90.4097.00	OR Ø 55.56x3.53 (159)	1
16	91.8331.00	Cuscinetto a sfere 6305 – Spec.	2
17	90.1614.00	Anello rad. Ø 20x30x5	23 3
18	44.0100.22	Carter pompa	1

POS	COD.	DESCRIZIONE – DESCRIPTION - KIT	NR
19	98.2103.00	Tappo carico olio G 3/8"	1
20	44.0203.35 44.0206.35	Albero – W140HH Albero – W130HH-W154HH	1 1
21	91.4892.00	Linguetta 8x7x35 UNI 6604	1
22	44.0500.66	Guida pistone	3
23	44.0300.22	Biella	3
24	90.3920.00	OR Ø 101.27x2.62 (3400)	1
25	44.1600.22	Coperchio posteriore	1
26	99.1837.00	Vite M6x14 UNI 5931	5
27	90.3585.00	OR Ø 10.82x1.78 (2043)	1
28	98.2041.00	Tappo G 1/4"x9	1
29	97.7340.00	Spinotto Ø 10x29.5	3
30	96.7350.00	Rosetta Ø 16x27x1.7/0.7	3
31	90.5022.00	Anello antiest. Ø 6.2x9x1.5	3
32	90.3572.00	OR Ø 5.28x1.78 (2021) – Spec.	3
33	52.0400.09 44.0401.09	Pistone Ø 15 Pistone Ø 18	3 3
34	44.2115.70	Rosetta Ø 8 con collare	3
35	92.2216.00	Dado M8x13x5 - INOX	3
36	90.1641.00	Anello rad. Ø 25x62x10	1
37	50.2000.74	Piedino	2
38	96.7016.00	Rosetta Ø 8.4 UNI 1751	4
39	99.3037.00	Vite M8x16 UNI 5739	4

POS	COD.	DESCRIZIONE – DESCRIPTION - KIT	NR
40	90.3612.00	OR Ø 31.47x1.78 (2125)	125-126 3
41	44.0800.70 44.0801.70	Anello di fondo Ø 15 Anello di fondo Ø 18	125 3 126 3
42	52.2166.70 44.2161.70	Anello intermedio Ø 15 Anello intermedio Ø 18	89 3 128 3
43	90.2622.00 90.2683.00	Anello RESTOP Ø 15 Anello RESTOP Ø 18	250 3 251 3
44	90.2620.00 90.2682.00	Anello tenuta Ø 15 HP Anello tenuta Ø 18 HP	250 6 251 6
45	51.1000.51 44.1001.51	Anello di testa Ø 15 Anello di testa Ø 18	90 6 129 6
46	98.2100.00	Tappo G 3/8"x13	1
47	98.2176.00	Tappo G 1/2"x10	1
48	96.7380.00	Rosetta Ø 17.5x23x1.5	1
49	96.7514.00	Rosetta Ø 21.5x27x1.5	1
50	98.1966.00	Tappo G 1/8"x8	1

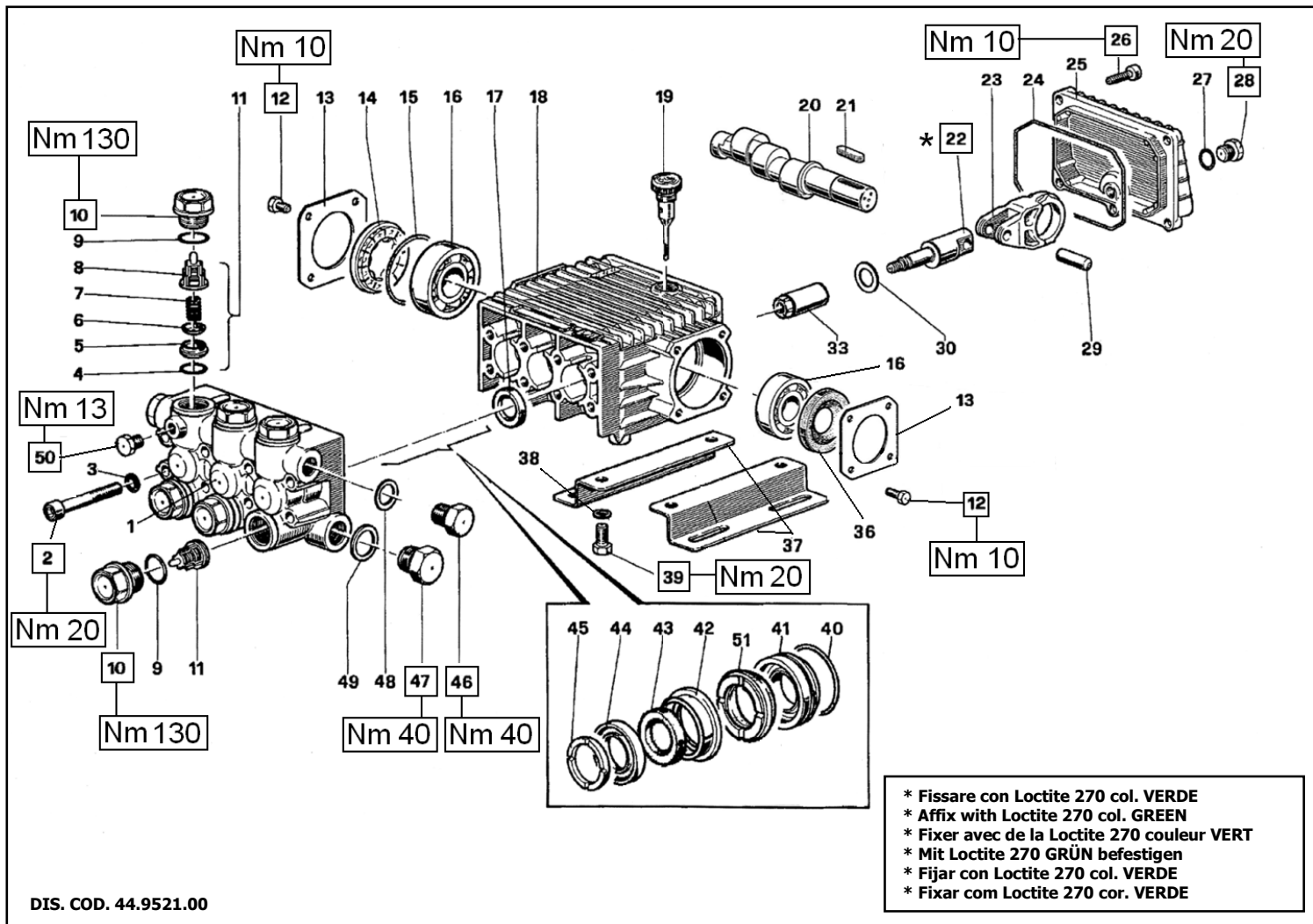

**KIT RICAMBI – SPARE KITS**

KIT Nr.	KIT 23	KIT 123	KIT 152	KIT 153	KIT 154	KIT 155	KIT 156	KIT 158
Posizioni incluse Positions included	17	4 – 5 6 – 7 8 - (11)	40 – 41	43 – 44 51	42	45	40 – 41 42 – 43 44 – 45 51	9 - 10
Nr. Pcs.	3	6	3	3	3	6	3	6

WW963 – WW964 – WW965

POS	COD.	DESCRIZIONE – DESCRIPTION - KIT	NR
1	44.1208.41	Testata Ø 13 - NICKEL	1
2	99.3175.00	Vite M8x60 UNI 5931	8
3	96.7014.00	Rosetta Ø 8.4x13x0.8	8
4	90.3841.00	OR Ø 17.13x2.62 (3068)	123 6
5	36.2003.66	Sede valvola	123 6
6	36.2001.76	Valvola	123 6
7	94.7376.00	Molla Ø 9.4x14.8	123 6
8	36.2025.51	Guida valvola	123 6
9	90.3847.00	OR Ø 20.24x2.62 (3081) 90 Sh.	158 6
10	98.2225.00	Tappo M24x1.5x17 - NICKEL	158 6
11	36.7115.01	Gruppo valvola aspiraz./mand.	123 6
12	99.1807.00	Vite M6x10 UNI 5739	8
13	50.1500.74	Coperchio carter	2
14	44.2118.01	Distanziale con indicatore	1
15	90.4097.00	OR Ø 55.56x3.53 (159)	1
16	91.8331.00	Cuscinetto a sfere 6305 – Spec.	2
17	90.1614.00	Anello rad. Ø 20x30x5	23 3
18	44.0100.22	Carter pompa	1
19	98.2103.00	Tappo carico olio G 3/8"	1
20	44.0200.35 44.0203.35 44.0206.35	Albero – WW963 Albero – WW964 Albero – WW965	1 1 1
21	91.4892.00	Linguetta 8x7x35 UNI 6604	1

POS	COD.	DESCRIZIONE – DESCRIPTION - KIT	NR
22	44.0501.66	Guida pistone	3
23	44.0300.22	Biella	3
24	90.3920.00	OR Ø 101.27x2.62 (3400)	1
25	44.1600.22	Coperchio posteriore	1
26	99.1837.00	Vite M6x14 UNI 5931	5
27	90.3585.00	OR Ø 10.82x1.78 (2043)	1
28	98.2041.00	Tappo G 1/4"x9	1
29	97.7340.00	Spinotto Ø 10x29.5	3
30	96.6967.00	Rosetta Ø 7.1x28x0.5	3
33	44.0402.66	Pistone Ø 13	3
36	90.1641.00	Anello rad. Ø 25x62x10	1
37	50.2000.74	Piedino	2
38	96.7016.00	Rosetta Ø 8.4 UNI 1751	4
39	99.3037.00	Vite M8x16 UNI 5739	4
40	90.3612.00	OR Ø 31.47x1.78 (2125)	152-156 3
41	44.0803.70	Anello di fondo Ø 13	152-156 3
42	52.2162.70	Anello intermedio Ø 13	154-156 3
43	90.5076.00	Anello antiest. Ø 13x17x2	153-156 3
44	90.2602.00	Anello tenuta Ø 13 HP	153-156 3
45	44.1002.51	Anello di testa Ø 13	155-156 3
46	98.2100.00	Tappo G 3/8"x13	1
47	98.2176.00	Tappo G 1/2"x10	1

POS	COD.	DESCRIZIONE – DESCRIPTION - KIT	NR
48	96.7380.00	Rosetta Ø 17.5x23x1.5	1
49	96.7514.00	Rosetta Ø 21.5x27x1.5	1
50	98.1967.00	Tappo G 1/8"x8 - NICKEL	1
51	90.2603.00	Anello tenuta Ø 13 LP	153-156 3